



This information is brought to you by  
Owls Hall Environmental working in  
partnership with Klargester products.



*Excellent Treatment*

**0845 375 1801**  
[www.ohel.co.uk](http://www.ohel.co.uk)

All New  
2006 Pump Range  
from Klargester  
with 24hr Storage



A Range of Package Pump Systems for  
Residential & Commercial Developments



[klargester.com](http://klargester.com)

  
**Klargester**

## Applications

**Developments where foul drainage by gravity is not possible, including:**

- **Domestic sewage pumping**
- **Effluent pumpsets for sewage treatment plants**
- **Surface water pumping systems**
- **Septic tank pumpsets**
- **24 hour storage chambers**
- **Bespoke systems**

## Features

- Complete package systems delivered direct to site
- Ready for immediate and simple installation
- Factory built and quality assured
- Maintenance free GRP and polyethylene chambers
- High-level alarm fitted as standard
- Full Klargestar after sales maintenance available
- All Klargestar products are manufactured under the quality procedures of BS ISO 9001: 2000

## Design

All standard Klargestar package pump systems are supplied with GRP/polyethylene chambers, pump(s), high-level alarm, pre-set automatic level control, non-return valve, discharge pipe and all connections.

## Options

- Wide range of emergency overflow tanks
- 110mm or 160mm inlet connections
- Various invert depths
- Standby replacement pumps

## Bespoke Systems

Klargester manufactures pumping chambers of various diameter and depths, with pumps, guide rails and control equipment fitted as per the client's specification. Please contact us direct and we will be pleased to quote against your specific requirements.

## Delivery and Installation

Units are normally delivered by flat bed vehicle and craneage facilities should be available on-site for off loading. Installation is quick and economical, the unit requiring only a concrete base and surround. Comprehensive installation instructions are supplied with every unit.

## Advice

The information in this sales literature is, by necessity, brief. For more detailed technical literature and drawings regarding applications, installation, maintenance or specific options, please contact Klargestar. We have both internal and field sales staff who will be pleased to assist.

## Maintenance

Klargester package pump systems are designed for minimum maintenance.

Klargester offers a full after sales service involving planned maintenance visits on the U.K. mainland.

## Legal Requirements

Prior to installation, there is a legal requirement to obtain permission from the appropriate agencies (including connection to a public sewer).

## 24hr Storage to Meet Building Regulations

The Klargestar **HillMaster24** pump station range has been designed in accordance with Building Regulations Document H1 Foul Drainage, page 16. (Pumping Installations) Section 2.39. This states:

*“Where foul drainage from a building is to be pumped, the effluent receiving chamber should be sized to contain 24 hour inflow to allow for disruption in service. The minimum daily discharge of foul drainage should be taken as 150 litres per head per day for domestic use. For other types of building, the capacity of the receiving chamber should be based on the calculated daily demand of the water intake for the building. Where only a proportion of the foul sewage is to be pumped, then the capacity should be based pro-rata. In all pumped systems the controls should be so arranged to optimise pump operation. The required 150 litres per head per day volume should reflect the storage volume in the station pump or station and overflow tanks.”*

## Domestic Sewage Pumpsets

If the main sewer is accessible but at a higher level to (or some distance from) the domestic foul drain, then a domestic sewage pumpset may be used to pump unsettled sewage directly to the main.

Whilst single pump units are acceptable for individual houses, it is recommended that twin pumping systems be used for multiple dwellings.

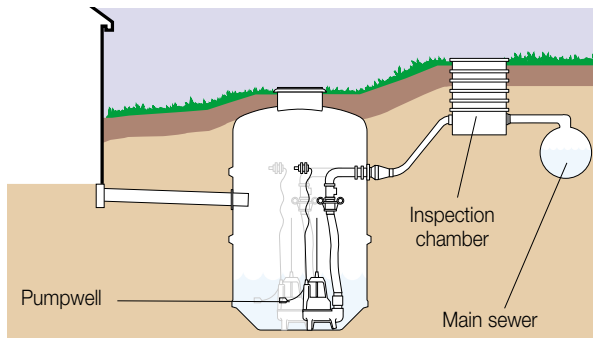

## Key Points to Consider

Firstly, don't worry. Klargester have a team of pump experts on hand to advise you on the correct product for your site. All we need from you is information on key factors such as:

- Application: e.g domestic residential / commercial
- Sewage, Effluent or Surface water?
- Inlet depth (below ground level)
- Pumping distance + lift
- Electrical supply

Simply give us a ring or log on to our website to download our Package Pumps Enquiry form. This form will guide you on what measurements you will need and any additional data. Once completed, phone, email, fax or post it back to us and our team will provide you with a solution.

## Effluent Pumpsets

A septic tank or treatment system pumpset can be used to disperse settled effluent when a site has a high water table or adverse invert levels. Installed after the septic tank or treatment system and pumping settled effluent up to an inspection chamber, flow to the drainage system then takes place by gravity in the normal way.

## Surface Water Pumpsets

Due to the amount of rainwater that can fall in a short time period, Surface Water run-off is often the most demanding of all applications, whether hard-standing or roof areas.

Klargester offers a comprehensive range of packaged pump systems in both standard form or manufactured to bespoke specifications. Careful calculation of the run-off areas is essential when sizing these pump systems.

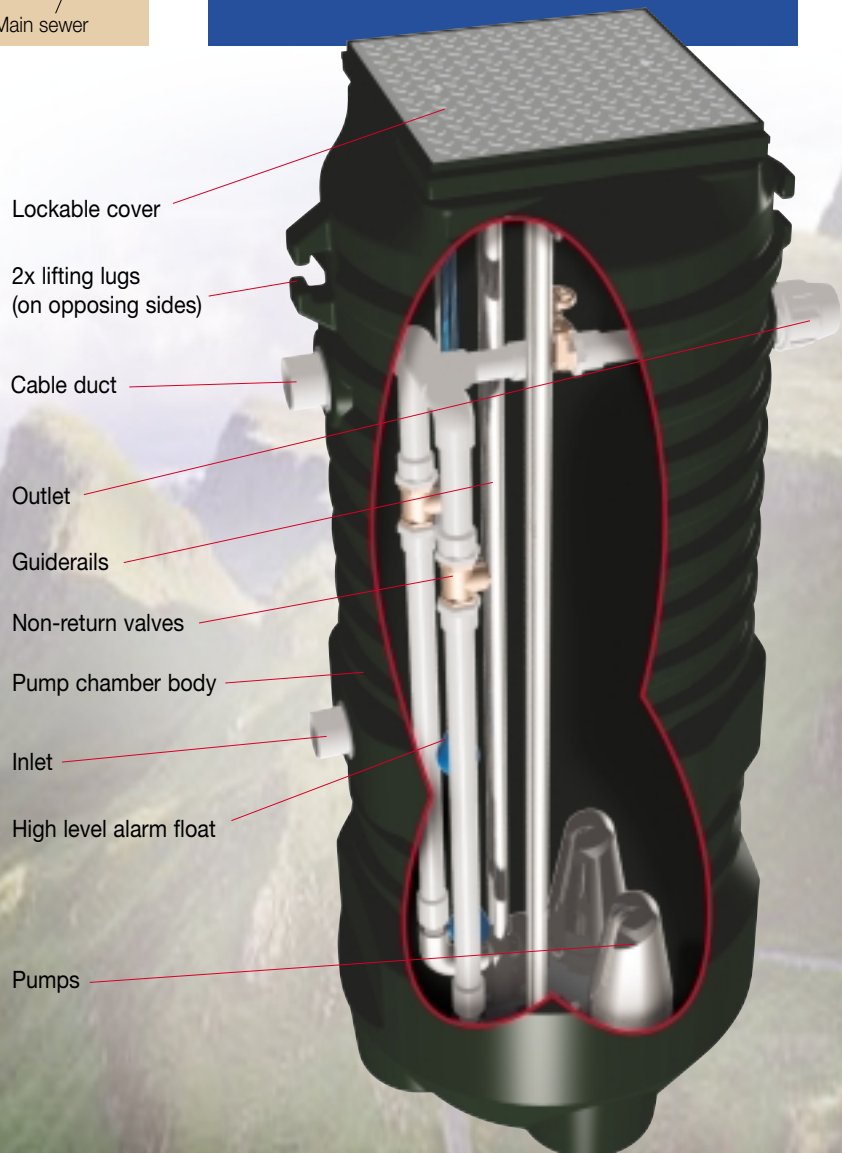

- Lockable cover
- 2x lifting lugs (on opposing sides)
- Cable duct
- Outlet
- Guiderails
- Non-return valves
- Pump chamber body
- Inlet
- High level alarm float
- Pumps

The HillMaster range offers a competitive solution to the pumping requirements of both domestic and industrial applications. Often it can be preferable to keep civil work and installation costs down to a minimum but such economy should not mean any shortfall in quality.

The Chiltern range is manufactured in tough polyethylene using advanced rotational-moulding technology, while the Pennine and Mendip ranges are made from maintenance-free GRP. All units are engineered with the highest quality parts and fittings.

- High-level alarm as standard (optional as marked \*)
- Various invert depths
- Internal lifting chains and guiderails (as specified)
- Wide range of pump options including grinders/macerators
- Pedestrian/vehicle covers



	Chiltern		Mendip			Pennine
	1.0m x 2.0m Roto-moulded	1.0m x 2.5m Roto-moulded	1.25m x 2.0m GRP	1.25m x 3.0m GRP	1.25m x 3.5m GRP	1.8m x 4.0m GRP
SINGLE PUMP	✓	✓	✓	✓	✓	✓
TWIN PUMP	✓	✓	✓	✓	✓	✓
SINGLE PUMP	✓	✓	✓	✓	✓	✓
TWIN PUMP	✓	✓	✓	✓	✓	✓
SINGLE PUMP	✓*	✓*	✓	✓	✓	✓
TWIN PUMP	✓	✓	✓	✓	✓	✓

✓ Represents standard models. ✓ Represents special order models. \* Optional High-level alarm.

**Need Help? Call the HillMaster Hotline on 0800 358 6067 or download our Pump Package Enquiry Form at [www.klargester.com/hillmaster](http://www.klargester.com/hillmaster)**

# HillMaster24

The HillMaster24 range has been specifically designed to meet the requirements of Building Regulations Document H1 Foul Drainage. This regulation recognises the need for pump stations to have a 24hr storage capacity in case of a disruption in service (such as a power failure).

This comprehensive range offers an advanced solution to larger domestic and industrial applications. For large-capacity flows (such as stormwater run-off from hard-standing areas), horizontal holding chambers are available in a comprehensive range of sizes.

- High-level alarm fitted as standard
- Various invert depths
- Internal lifting chains and guiderails fitted as standard
- Wide range of pump options including grinders/macerators
- Combined chamber capacity up to 90,000 litres
- Pumping distances up to 1000 metres
- Pedestrian/vehicle covers



Mendip 1.25m x 3.0m GRP	Pennine 1.8m x 3.0m GRP	Cairngorm 2.6m diameter pump chambers GRP
✓	✓	✓
✓	✓	✓
✓	✓	✓
✓	✓	✓
✓	✓	✓

✓ Represents standard models. ✓ Represents special order models.

**Need Help?** Call the HillMaster Hotline on 0800 358 6067 or download our Pump Package Enquiry Form at [www.klargester.com/hillmaster](http://www.klargester.com/hillmaster)

# Klargester Off-Mains Solutions

**TREAT IT!**



**PUMP IT!**

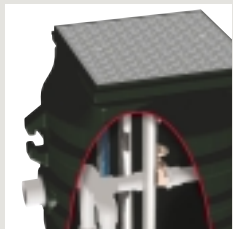

**STORE IT!**



**SEPARATE IT!**

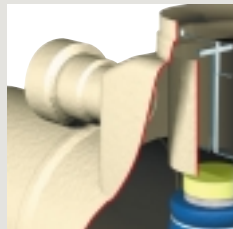

**SAVE IT!**

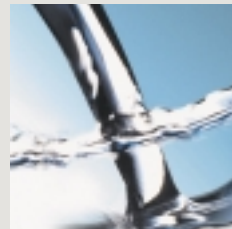

- BioDisc® Sewage Treatment Plants
- AirFlow Sewage Treatment Plants
- Sigma Sewage Treatment Plants
- HillMaster Package Pump Systems
- Septic Tanks
- Cesspools
- Grease Traps
- Oil/Water Separators
- Silage Effluent Tanks
- Reed Beds
- Rainwater Harvesting

## Nationwide Availability

Klargester products can be sourced from your local builders merchant or pollution control specialists.

## Klargester Service

Whatever the system selected, Klargester have an extensive support package available for maintenance and parts.

Our extensive nationwide team of trained engineers carry out inspection, service and maintenance.



## Certified Installers

Strategically located throughout the UK, Klargester Certified Installers are appointed following rigorous selection procedures which assess their installation expertise, reputation and financial status.

These performance criteria, together with their design skills and knowledge of Klargester products are also reviewed on an annual basis to ensure that the highest levels of professionalism are maintained.



# Klargester

## Klargester Environmental

Head Office: College Road North, Aston Clinton, Aylesbury, Buckinghamshire HP22 5EW  
Tel: +44 (0) 1296 633000 Fax: +44 (0) 1296 633001 Sales Office Tel: +44 (0) 1296 633033 email:uksales@klargestere.com  
Scotland Office Tel: +44 (0) 1355 248484 Fax: +44 (0) 1355 235601

[klargestere.com](http://klargestere.com)